



## Space matters

Optimize your bar space

SOFT DRINKS | BEER | WINE

**Digitalize the dispensing of beer and wine** by using Drafter instead of a traditional beer tower.

**Maximize your space** behind the bar and **avoid time consuming inventory.**

- ✓ Easy to install
- ✓ Up to 6 premix drinks
- ✓ Remote settings capabilities
- ✓ Track your dispensed volumes
- ✓ POS integration



Reference  
03.03.54

4G  
LTE  
Connected equipment  
to Loop<sup>360</sup> Analytics



## Dimensions

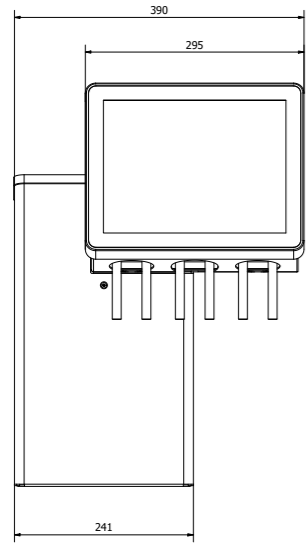

Front view

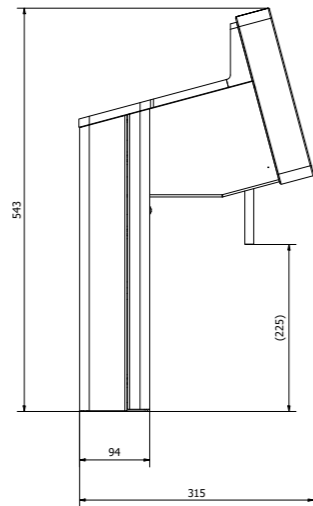

Lateral left view

## Main features

- ✓ **Small footprint**  
315 mm depth
- ✓ **Premix beverages:**  
wine, beer, juice, etc.

- ✓ **12" touch screen**
- ✓ **Customizable portions and prices**

## Technical features

- ✓ **Physical data**  
height: 543 mm  
width: 390 mm  
depth: 315 mm  
weight: 15.5 kg
- ✓ **Electrical data**  
mains voltage:  
male plug type F / type J  
100-240 V  
frequency: 50 Hz  
power: 90 W  
AC current:  
0.95A@115VAC  
0.5A@230VAC  
0.4A@277VAC

## DRAFTER

Technical specifications

## Back room requirements

- 1 - Drafter
- 2 - Cooler
- 3 - Premix kegs
- 4 - CO<sub>2</sub> bottle

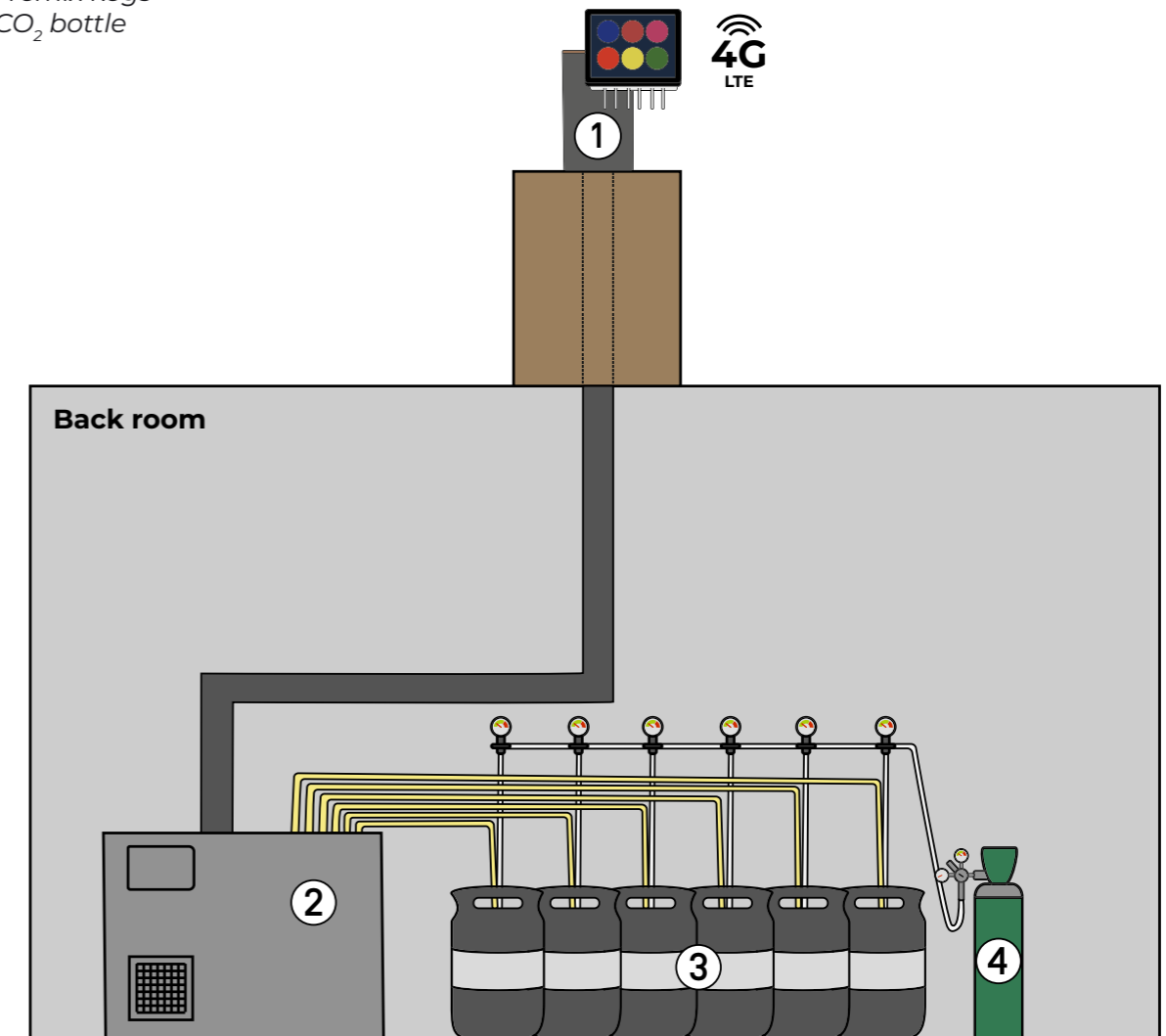

Non-contractual layout

# DRAFTER

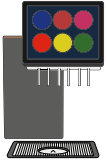

Tray type ETS-2

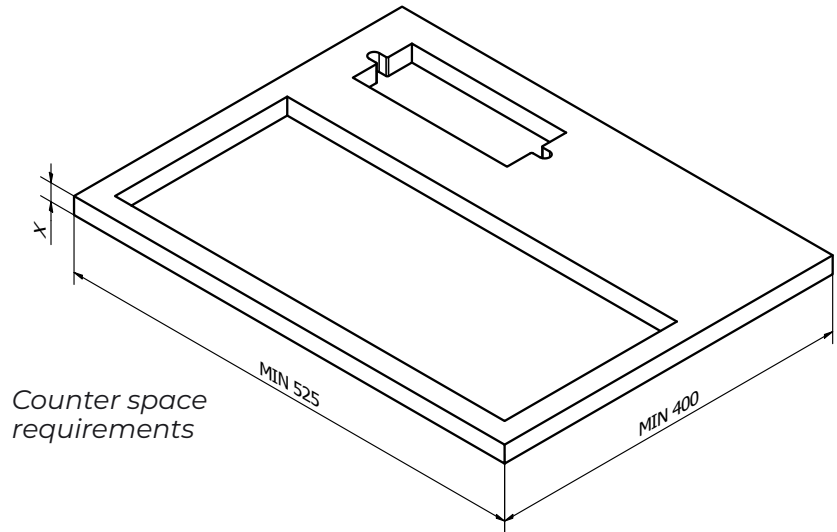

Counter space requirements

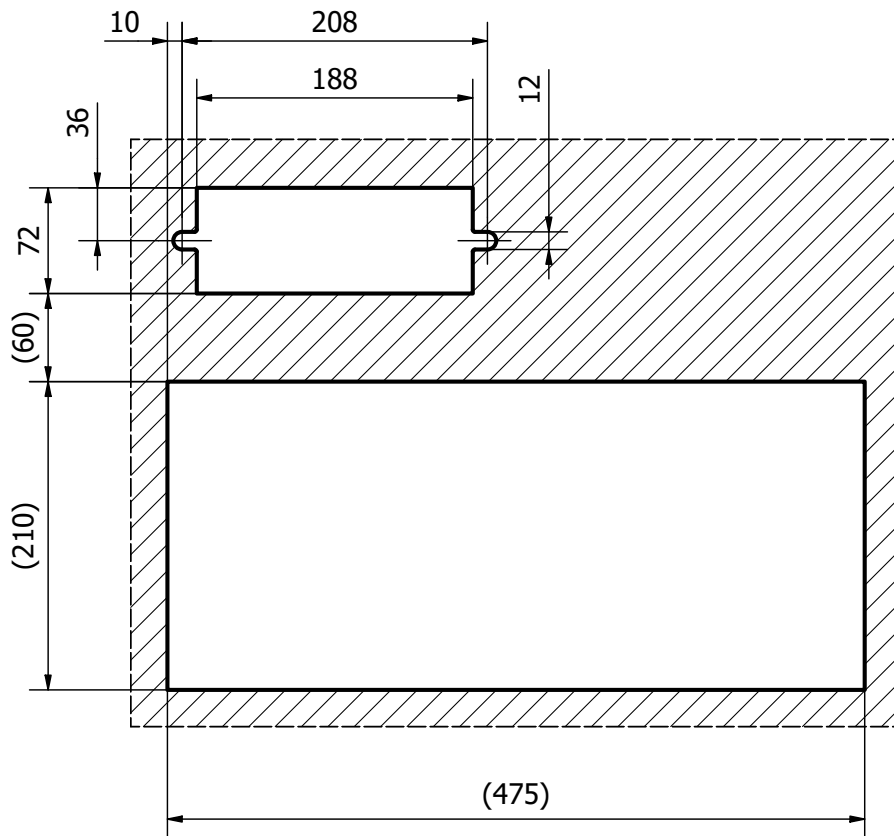

Counter cutting drawing